

COMPACT

Compact and small power supply that easily fits into an electrical gang box. This power supply can be also used for surface mounting.

The PSDIN12V18W1,5A can power a reader and a magnet at the same time.



FEATURES

Voltage In: from 110 to 240 VAC - 50/60 Hz

Voltage Out: 12 VDC

Current max.: 1,5 A

Power max.: 18 W

Voltage monitoring: LED

Dimensions: diameter \varnothing : 58,5 mm - h: 32 mm / 48,5 x 51,5 x 32 mm (LxWxH)

MONTAGING



Fixing for surface
mounting

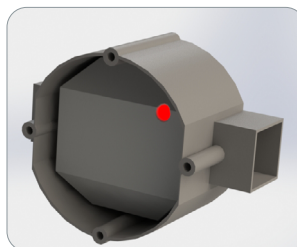

Mounting in electrical gang box

